

OPERATION

This valve allows free flow from 1 to 2 and blocks flow from 2 to 1.

SPECIFICATIONS

Theoretical performance

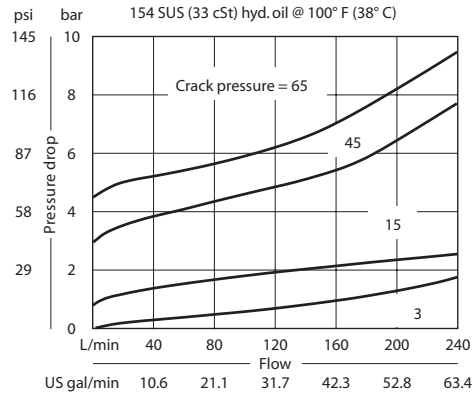

Schematic



Specifications

Rated pressure	350 bar 5075 psi
Rated flow at 7 bar	230 l/min
100 psi	61 US gal/min
Leakage	5 drops/min @ Rated pressure
Weight	1.91 kg 4.21 lb
Cavity	none

DIMENSIONS

mm in

Cross-sectional view

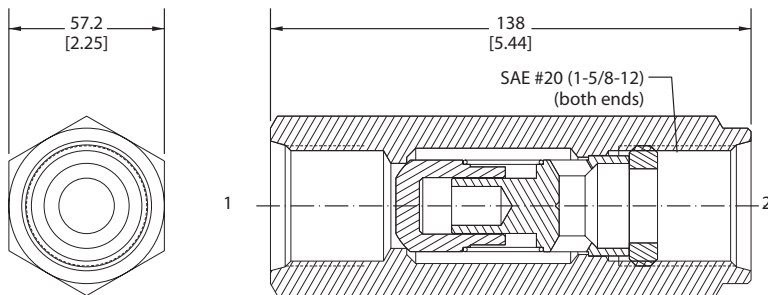

ORDERING INFORMATION

3C16-01-20S-3

Crack pressure

- 3 = 0.2 bar [3 psi]
- 15 = 1.0 bar [15 psi]
- 45 = 3.1 bar [45 psi]
- 65 = 4.5 bar [65 psi]

Port sizes

20S = SAE #20